

Forward curved centrifugal blowers in aluminum housing
Wheel diameter: 120 mm

Power supply: 230 V, 50 Hz

Temperature range: -25 +50 °C

Material: Electric motor – EC external rotor motor
Housing – die cast aluminum alloy
Impeller – galvanized steel

Insulation class: «B»

Bearings: industrial ball bearings, maintenance-free

Operation mode: continuous duty (S1)



Type	Power input, W	Air flow, m³/h	Static pressure, Pa	Speed, min ⁻¹	Speed Control	Weight, kg
VFS-120-EC-A-1	86	340	400	2800	0-10V / PWM	2,2
VFS-120-EC-B-1	86	340	400	2800	0-10V / PWM	2,2

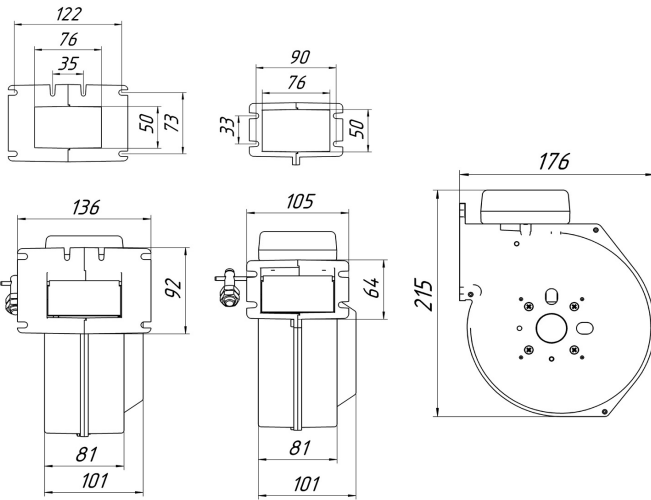

Mechanical modification «A»

Mechanical modification «B»

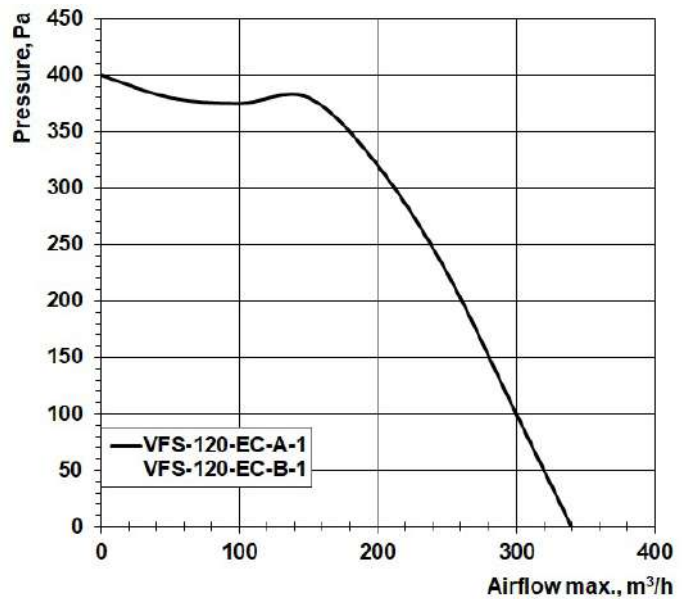

Additional options

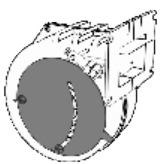

Shutter

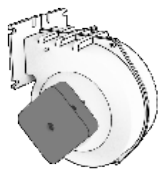

Junction Box on the Side

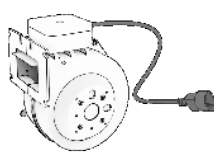

Longer Cable



Black Color Housing

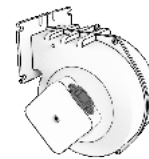

IEC Socket



Hall Sensor



Forward curved centrifugal blowers in aluminum housing
Standard mounting flange
Wheel diameter: 140 mm

Power supply: 230 V, 50 Hz

Temperature range: -25 +50 °C

Material: Electric motor – EC external rotor motor
Housing – die cast aluminum alloy
Impeller – galvanized steel

Insulation class: «B»

Bearings: industrial ball bearings, maintenance-free

Operation mode: continuous duty (S1)



Type	Power input, W	Air flow, m³/h	Static pressure, Pa	Speed, min ⁻¹	Motor capacitor, µF	Weight, kg
VFS-140-EC-A-1	165	568	407	2544	0-10V / PWM	3

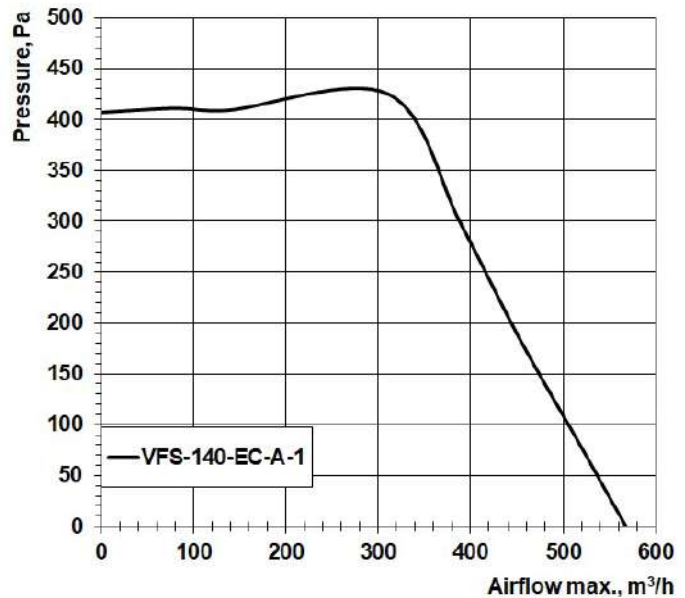
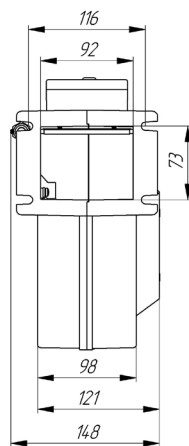
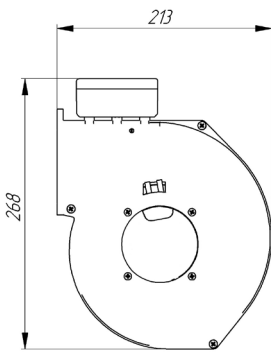

Additional options

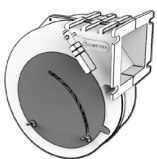

Shutter



Junction Box
on the Side

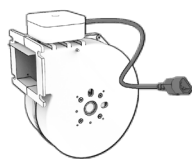

Longer Cable



Black Color
Housing

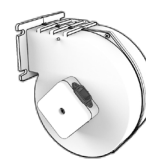

IEC Socket

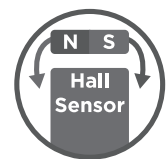

Hall Sensor



Forward curved centrifugal blowers in aluminum housing
Standard mounting flange
Wheel diameter: 160 mm

Power supply: 230 V, 50 Hz

Temperature range: -25 +50 °C

Material: Electric motor – EC external rotor motor
Housing – die cast aluminum alloy
Impeller – galvanized steel

Insulation class: «B»

Bearings: industrial ball bearings, maintenance-free

Operation mode: continuous duty (S1)

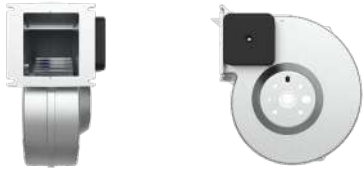

Type	Power input, W	Air flow, m ³ /h	Static pressure, Pa	Speed, min ⁻¹	Motor capacitor, µF	Weight, kg
VFS-160-EC-A-1	179	730	440	2600	0-10V / PWM	3,8

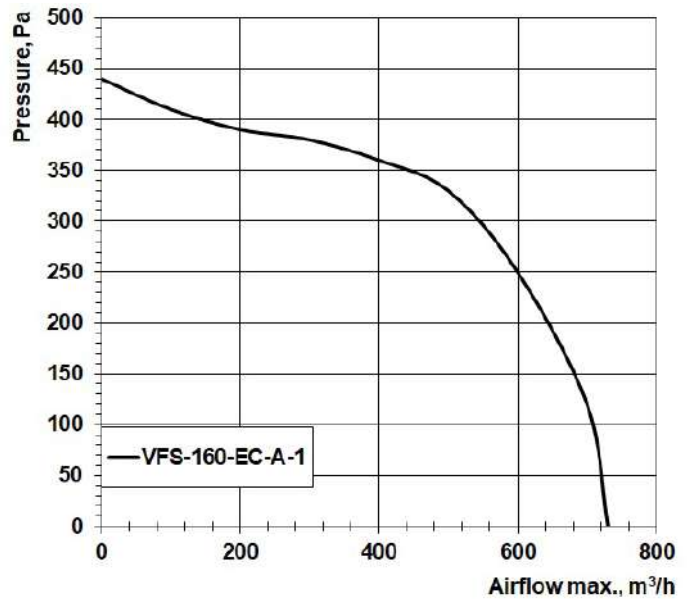
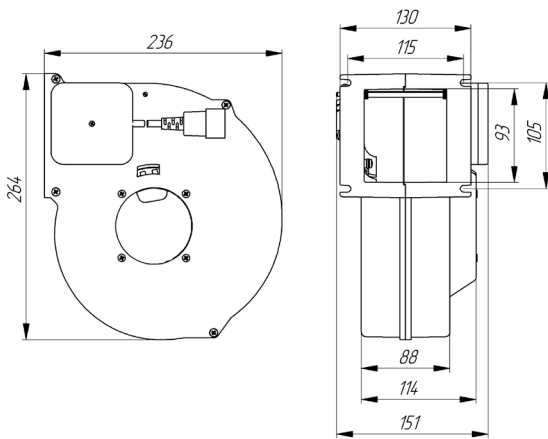

Additional options



Shutter



Junction Box
on the Side

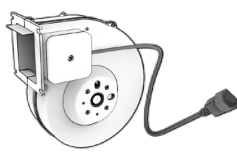

Longer Cable



Black Color
Housing



IEC Socket

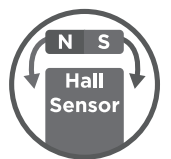

Hall Sensor